

THE UNIVERSITY OF SOUTH CAROLINA

PROJECT NO.: H27-6017-PG-C

HOBCAW EDUCATION CENTER [NERR]: DAM MAINTENANCE AND EDUCATIONAL WATER CONTROL SYSTEM REPLACEMENT

DECEMBER 03, 2012



22 HOBCAW ROAD, GEORGETOWN, SC 29440

BID DOCUMENTS

ARCHITECTURAL

LS3P ASSOCIATES, LTD.
701-A Lady Street
Columbia, SC 29201
Tel: (803) 765-2418
Fax: (803) 765-2419

CIVIL ENGINEER

SEAMON WHITESIDE & ASSOC.
501 Wando Park Blvd, Suite 200
Mount Pleasant, SC 29464
Tel: (803) 884-1667
Fax: (803) 884-6944

SURVEYING

ROBERT L BELLAMY & ASSOC.
4706 Oleander Drive
Myrtle Beach, SC 29577
Tel: (843) 449-9453
Fax: (843) 449-8359

GEOTECHNICAL

THE TOLLESON LIMITED COMPANY
136 Stonemark Lane, Suite 110
Columbia, SC 29210
Tel: (803) 783-9013
Fax: (803) 783-9210

KIMBEL POND MAINTENANCE REPAIR WORK

THE UNIVERSITY OF SOUTH CAROLINA

GEORGETOWN, SC

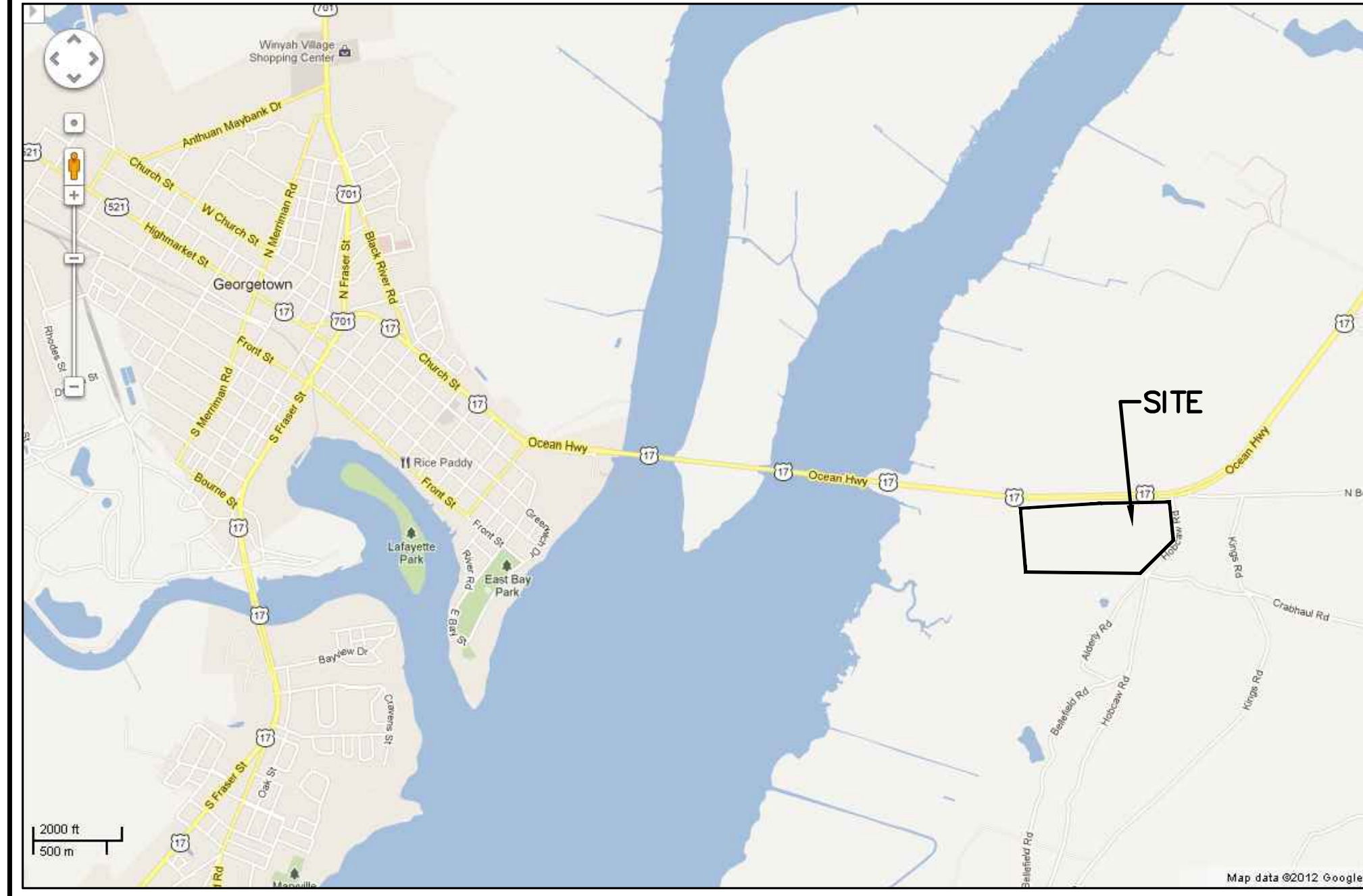

LOCATION MAP (NOT TO SCALE)

PROJECT TEAM

PROPERTY OWNER	THE BELLE W. BARUCH FOUNDATION 22 HOBCEW RD. GEORGETOWN, SC 29440 GEORGE CHASTAIN PHONE: (843)904-9010
DEVELOPER	THE UNIVERSITY OF SOUTH CAROLINA 743 GREEN ST. COLUMBIA, SC 29208 GENE BOBROW PHONE: (803)777-4569
ENGINEER	SEAMON, WHITESIDE, & ASSOCIATES, INC. 501 WANDO PARK BLVD., STE 200 MT. PLEASANT, SC 29464 SARAH MOORE PHONE: (843)884-1667

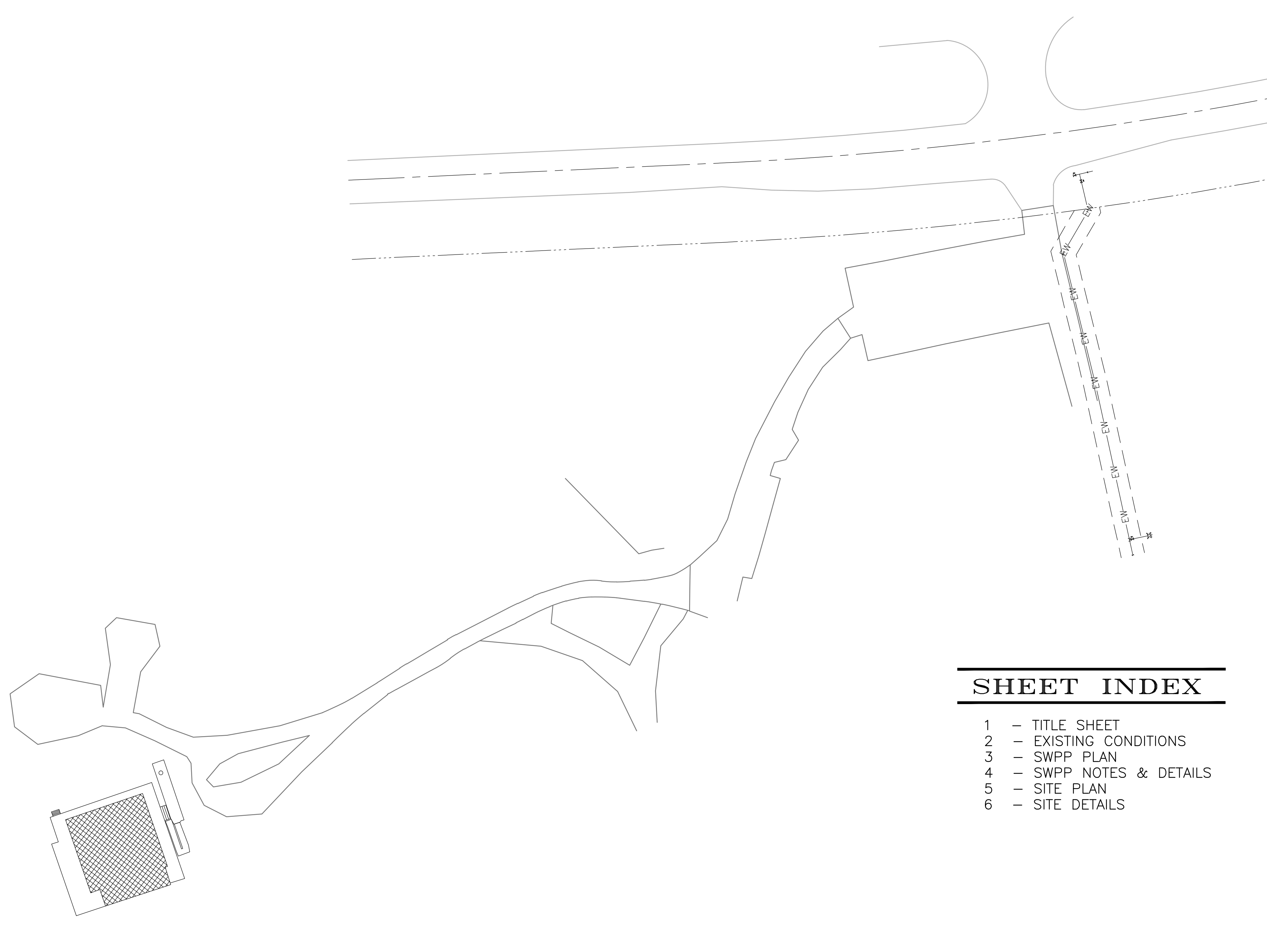

SHEET INDEX

- 1 - TITLE SHEET
- 2 - EXISTING CONDITIONS
- 3 - SWPP PLAN
- 4 - SWPP NOTES & DETAILS
- 5 - SITE PLAN
- 6 - SITE DETAILS

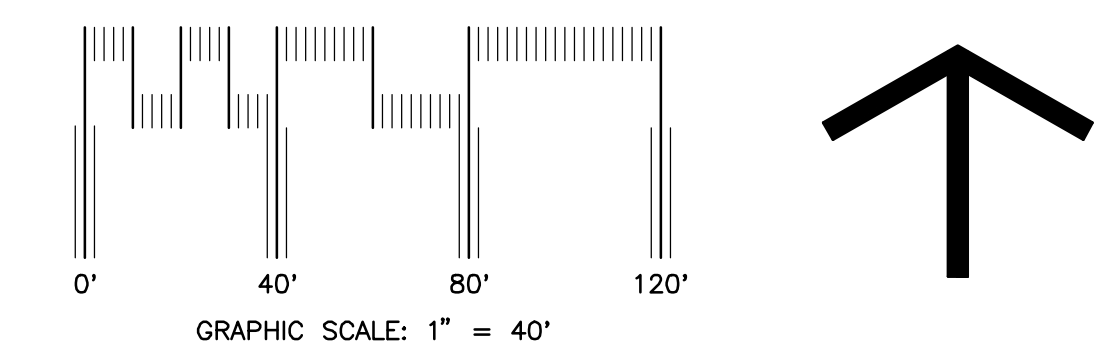

THIS DRAWING SHALL NOT BE REPRODUCED IN ANY MANNER OR USED FOR ANY PURPOSE WITHOUT WRITTEN PERMISSION

COPYRIGHT © SEAMON, WHITESIDE & ASSOCIATES, INC.

HOBCEW
EDUCATION
CENTER (NERR):
DAM MAINTENANCE
AND EDUCATIONAL
WATER CONTROL
SYSTEM
REPLACEMENT

THE BELLE W. BARUCH
FOUNDATION
&
THE UNIVERSITY OF
SOUTH CAROLINA

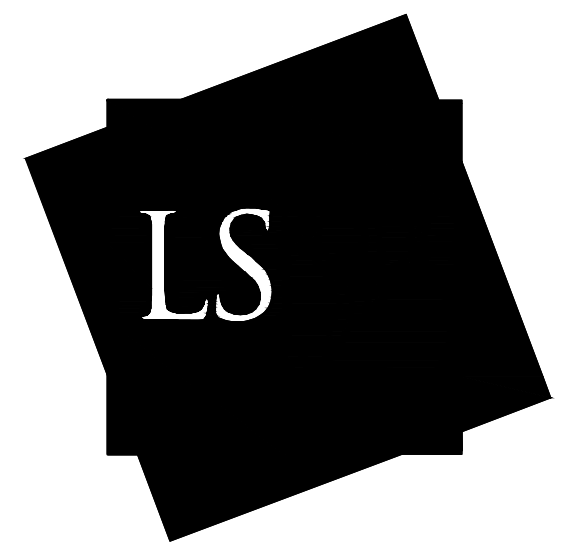
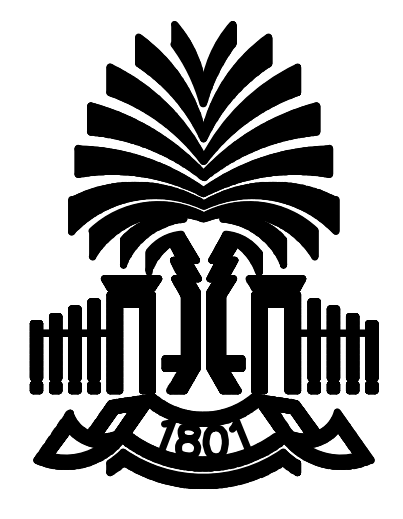

LS3P ASSOCIATES LTD.
701-A LADY STREET, COLUMBIA SC 29201
TEL. 803.765.2418 FAX 803.251.4769
WWW.LS3P.COM

SeamonWhiteside + ASSOCIATES
Civil Engineering Urban Design
607 Pendleton Street, Suite 300
Greenville, SC 29601-3319
864.298.0534 (F) 864.298.8018

Land Planning Landscape Architecture
501 Wando Park Blvd., Suite 200
Mount Pleasant, SC 29464-7949
843.884.1667 (F) 843.884.6944

MEMBERS OF THE AMERICAN INSTITUTE OF ARCHITECTS
COPYRIGHT 2012 ALL RIGHTS RESERVED
PRINTED OR ELECTRONIC DRAWINGS AND
DOCUMENTATION MAY NOT BE REPRODUCED
IN ANY FORM WITHOUT WRITTEN PERMISSION
FROM LS3P ASSOCIATES LTD.

REVISIONS:

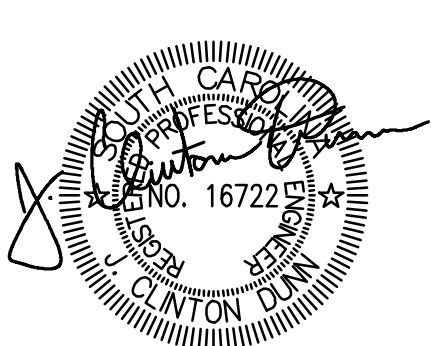

PROJECT: 2402-062141
DATE: DECEMBER 3, 2012
DRAWN BY:
CHECKED BY:

SHEET 1 OF 6

TITLE SHEET

THIS DRAWING SHALL NOT BE REPRODUCED IN ANY MANNER OR USED FOR ANY PURPOSE WITHOUT WRITTEN PERMISSION

COPYRIGHT © SEAMON, WHITESIDE & ASSOCIATES, INC.

**HOBCAW
EDUCATION
CENTER [NERR]:**
**DAM MAINTENANCE
AND EDUCATIONAL
WATER CONTROL
SYSTEM
REPLACEMENT**

THE BELLE W. BARUCH
FOUNDATION
&
THE UNIVERSITY OF
SOUTH CAROLINA

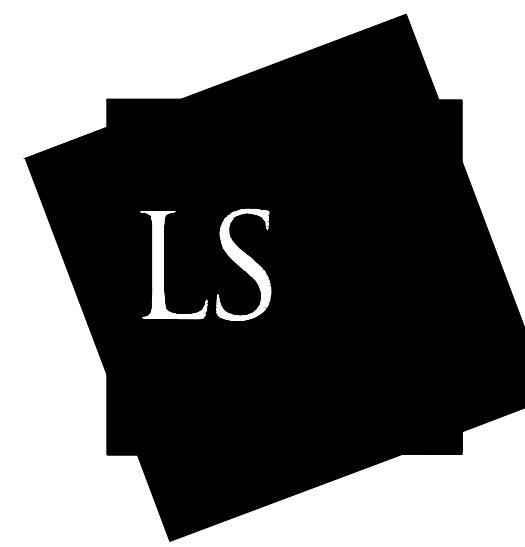

LS3P ASSOCIATES LTD.
701-A LADY STREET, COLUMBIA SC 29201
TEL. 803.765.2418 FAX 803.251.4769
WWW.LS3P.COM

**SeamonWhiteside
+ ASSOCIATES**

Urban Design
Civil Engineering
607 Pendleton Street, Suite 300
Greenville, SC 29601-3319
864.298.0534 (F) 864.298.8018

Land Planning
Landscape Architecture
501 Wando Park Blvd., Suite 200
Mount Pleasant, SC 29464-7949
843.884.1667 (F) 843.884.6944

MEMBERS OF THE AMERICAN INSTITUTE OF ARCHITECTS
COPYRIGHT 2012 ALL RIGHTS RESERVED
PRINTED OR ELECTRONIC DRAWINGS AND
DOCUMENTATION MAY NOT BE REPRODUCED
IN ANY FORM WITHOUT WRITTEN PERMISSION
FROM LS3P ASSOCIATES LTD.

REVISIONS:



PROJECT: 2402-062141
DATE: DECEMBER 3, 2012
DRAWN BY:
CHECKED BY:

SHEET 2 OF 6

EXISTING
CONDITIONS

SOLUTIONS THROUGH LISTENING
SERVICE BY DESIGN
BID DOCUMENTS

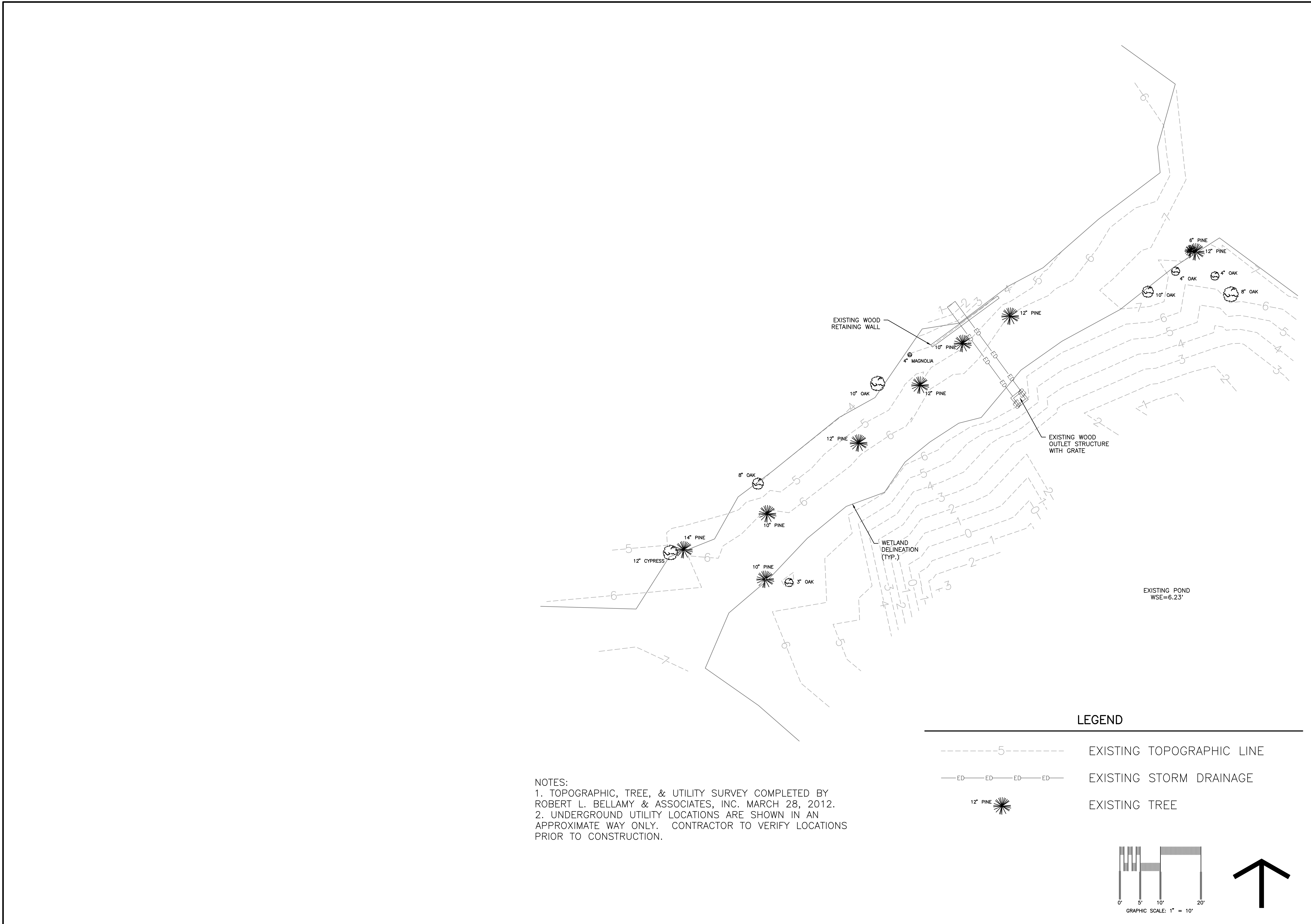

NOTES:
1. TOPOGRAPHIC, TREE, & UTILITY SURVEY COMPLETED BY ROBERT L. BELLAMY & ASSOCIATES, INC. MARCH 28, 2012.
2. UNDERGROUND UTILITY LOCATIONS ARE SHOWN IN AN APPROXIMATE WAY ONLY. CONTRACTOR TO VERIFY LOCATIONS PRIOR TO CONSTRUCTION.

LEGEND

---5--- EXISTING TOPOGRAPHIC LINE

—ED—ED—ED—ED— EXISTING STORM DRAINAGE

12" PINE EXISTING TREE

0' 5' 10' 20'
GRAPHIC SCALE: 1" = 10'

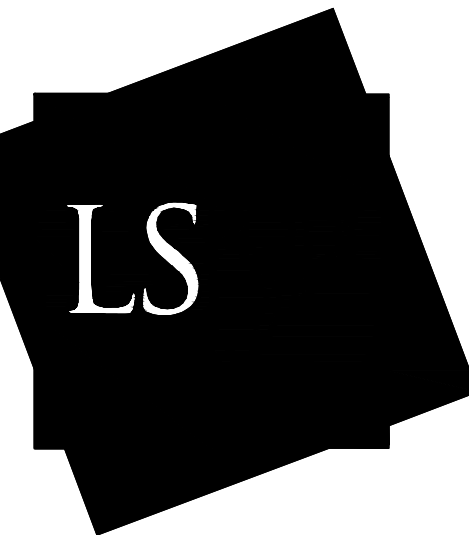
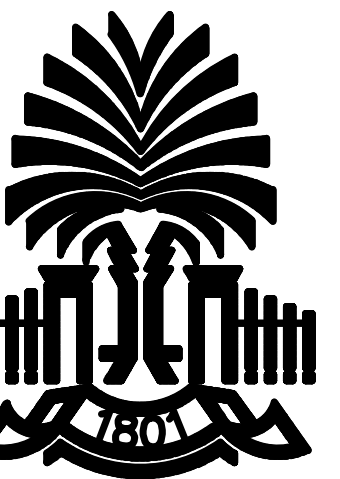

SeamonWhiteside
+ ASSOCIATES

Land Planning Landscape Architecture Civil Engineering Urban Design

501 Wando Park Blvd., Suite 200
Mount Pleasant, SC 29464-7949
843.884.1667 (F) 843.884.6944

607 Pendleton Street, Suite 300
Greenville, SC 29601-3319
864.298.0534 (F) 864.298.8018

MEMBERS OF THE AMERICAN INSTITUTE OF ARCHITECTS
COPYRIGHT 2012 ALL RIGHTS RESERVED
PRINTED OR ELECTRONIC DRAWINGS AND
DOCUMENTATION MAY NOT BE REPRODUCED
IN ANY FORM WITHOUT WRITTEN PERMISSION
FROM LS3P ASSOCIATES LTD.

REVISIONS:



PROJECT: 2402-062141
DATE: DECEMBER 3, 2012
DRAWN BY:
CHECKED BY:

SHEET 3 OF 6

SWPP
PLAN

THIS DRAWING SHALL NOT BE REPRODUCED IN ANY MANNER OR USED FOR ANY PURPOSE WITHOUT WRITTEN PERMISSION

COPYRIGHT © SEAMON, WHITESIDE & ASSOCIATES, INC.

NOTES:

THE WATER LEVEL IN THE EXISTING POND IS TO BE MAINTAINED DURING CONSTRUCTION TO PRESERVE THE EXISTING FISH AND WILDLIFE IN THE POND. AS SUCH, THE CONTRACTOR IS TO PROVIDE THE FOLLOWING, AS REQUIRED, TO ENABLE THE EXECUTION OF THE SCOPE OF WORK AND MAINTAIN THE EXISTING WATER LEVEL FOR THE DURATION OF CONSTRUCTION:

1. TEMPORARY BULKHEAD AND/OR COFFERDAM AND/OR PORTABLE COFFERDAM.
 - A. PREPARE AND PROVIDE SHOP DRAWINGS FOR REVIEW PRIOR TO CONSTRUCTION/INSTALLATION.
2. INTERIM MEANS FOR STORM WATER RUN-OFF TO THE EXISTING SPILLWAY.

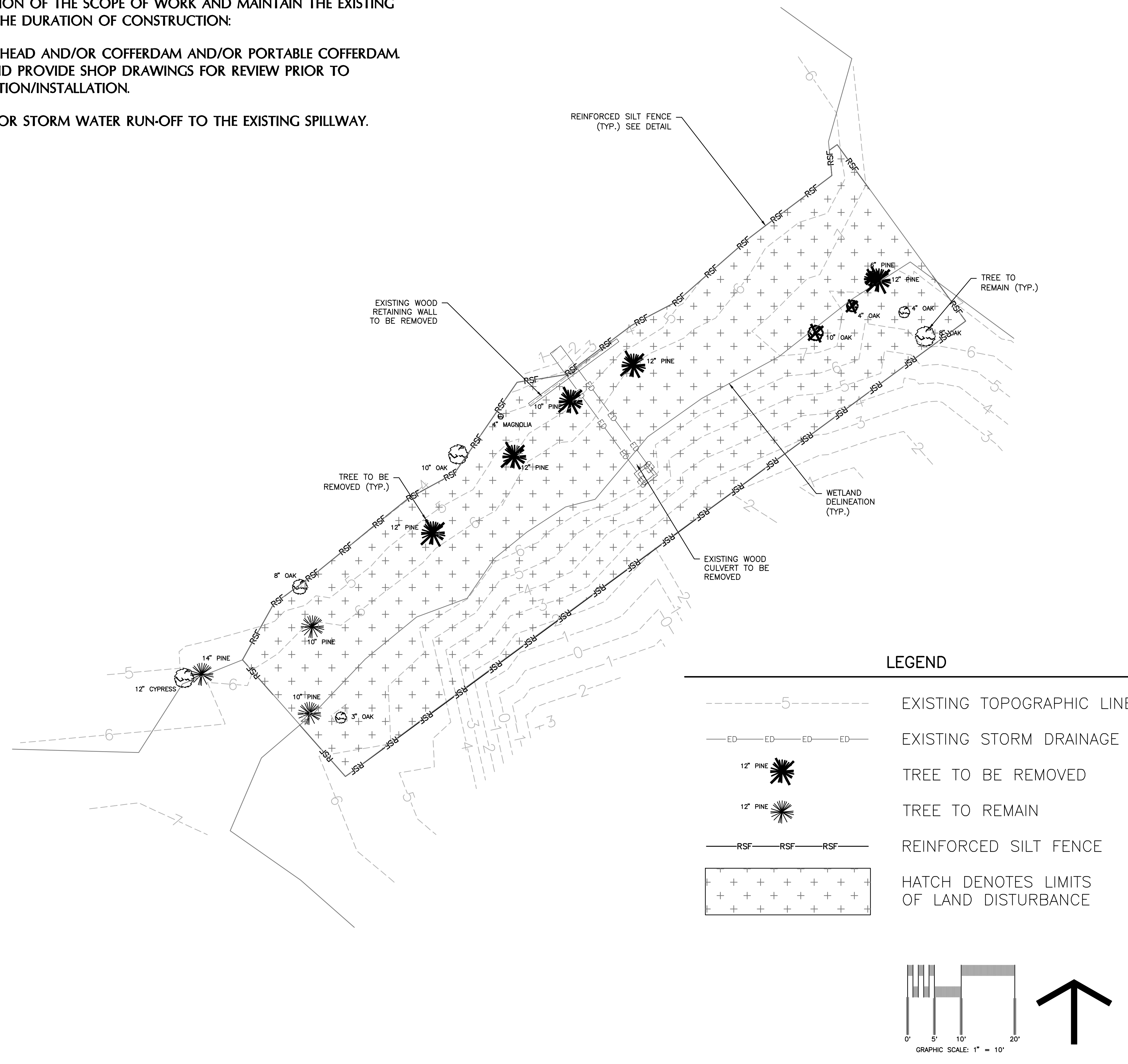

THIS DRAWING SHALL NOT BE REPRODUCED IN ANY MANNER OR USED FOR ANY PURPOSE WITHOUT WRITTEN PERMISSION

COPYRIGHT © SEAMON, WHITESIDE & ASSOCIATES, INC.

NOTES:

THE WATER LEVEL IN THE EXISTING POND IS TO BE MAINTAINED DURING CONSTRUCTION TO PRESERVE THE EXISTING FISH AND WILDLIFE IN THE POND. AS SUCH, THE CONTRACTOR IS TO PROVIDE THE FOLLOWING, AS REQUIRED, TO ENABLE THE EXECUTION OF THE SCOPE OF WORK AND MAINTAIN THE EXISTING WATER LEVEL FOR THE DURATION OF CONSTRUCTION:

1. TEMPORARY BULKHEAD AND/OR COFFERDAM AND/OR PORTABLE COFFERDAM.
 - A. PREPARE AND PROVIDE SHOP DRAWINGS FOR REVIEW PRIOR TO CONSTRUCTION/INSTALLATION.
2. INTERIM MEANS FOR STORM WATER RUN-OFF TO THE EXISTING SPILLWAY.

Pre-Approved Rice Trunk Fabricators:

Keary Mull
843-344-3119
550 Wildwood Ave.
Georgetown, SC 29440

Bryan Reece
843-545-9594
1 Yawkey Way South
Georgetown, SC 29440

Bill Mace
250 Santee Gun Club Rd.
McClellanville, SC 29458
843-546-9797

Pre-Approved Rice Trunk Installers:

Thomas Bone Construction
264-5907
542 Old Cemetery Road
Andrews, SC 29520

Ricky Jayroe
Wetlands Improvement
843-833-0435

William Neely
237-8602 or 237-9007

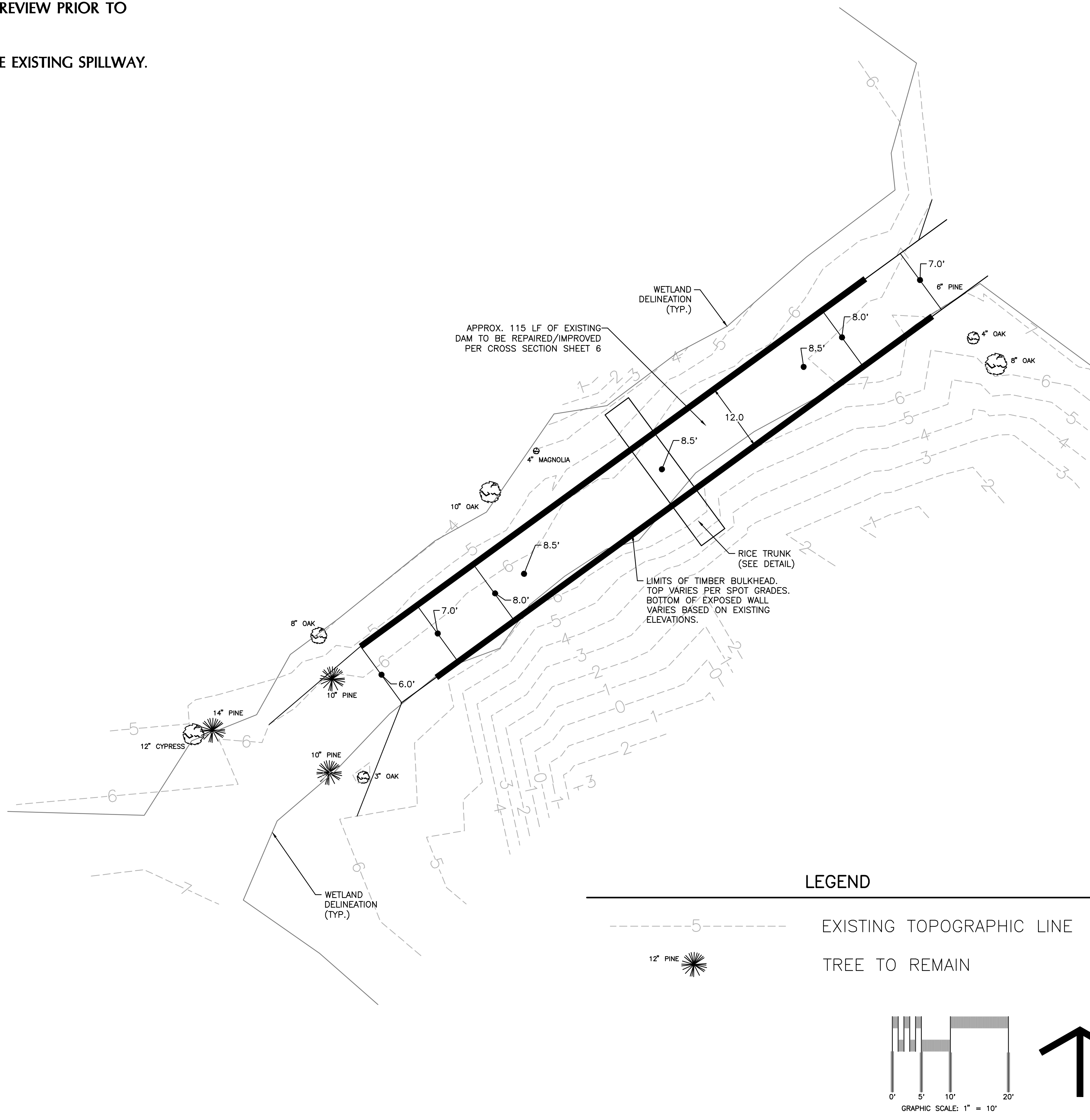

**HOBCAW
EDUCATION
CENTER [NERR]:**
**DAM MAINTENANCE
AND EDUCATIONAL
WATER CONTROL
SYSTEM
REPLACEMENT**

THE BELLE W. BARUCH
FOUNDATION
&
THE UNIVERSITY OF
SOUTH CAROLINA

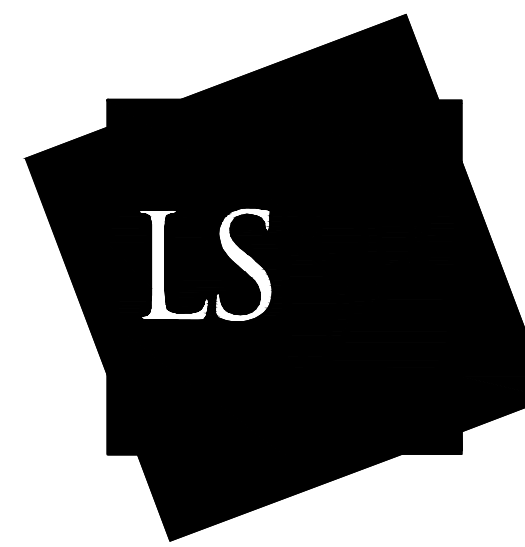

LS3P ASSOCIATES LTD.
701-A LADY STREET, COLUMBIA SC 29201
TEL. 803.765.2418 FAX 803.251.4769
WWW.LS3P.COM

**SeamonWhiteside
+ ASSOCIATES**

Urban Design
Civil Engineering
607 Pendleton Street, Suite 300
Greenville, SC 29601-3319
864.298.0534 (F) 864.298.8018

Land Planning
Landscape Architecture
501 Wando Park Blvd., Suite 200
Mount Pleasant, SC 29464-7949
843.884.1667 (F) 843.884.6944

MEMBERS OF THE AMERICAN INSTITUTE OF ARCHITECTS
COPYRIGHT 2012 ALL RIGHTS RESERVED
PRINTED OR ELECTRONIC DRAWINGS AND
DOCUMENTATION MAY NOT BE REPRODUCED
IN ANY FORM WITHOUT WRITTEN PERMISSION
FROM LS3P ASSOCIATES LTD.

REVISIONS:

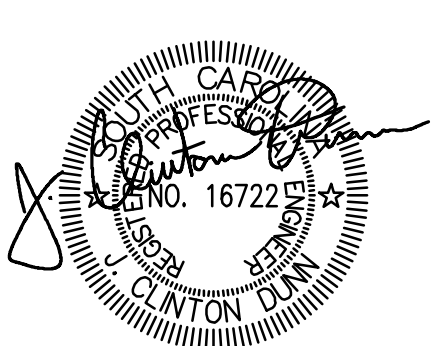

PROJECT: 2402-062141
DATE: DECEMBER 3, 2012
DRAWN BY:
CHECKED BY:

SHEET 5 OF 6

**SITE
PLAN**

SOLUTIONS THROUGH LISTENING
SERVICE BY DESIGN
BID DOCUMENTS

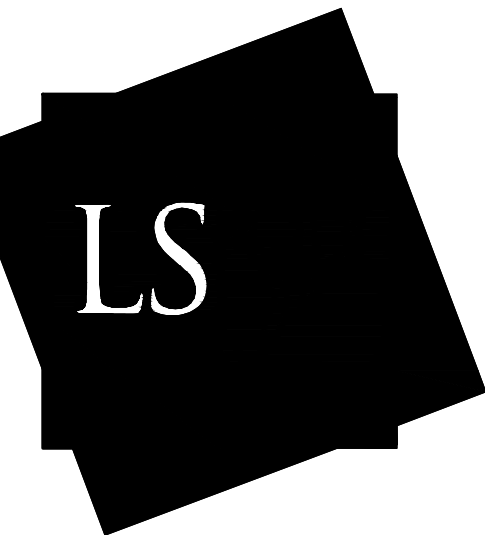
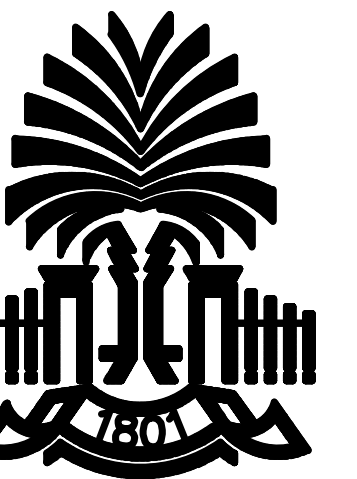

SeamonWhiteside
+ ASSOCIATES
Civil Engineering
Urban Design
Landscape Architecture
Land Planning
501 Wando Park Blvd., Suite 200
Mount Pleasant, SC 29567-7949
843.884.1667 (F) 843.884.6944
607 Pendleton Street, Suite 100
Greenville, SC 29601-3319
864.298.0534 (F) 864.298.8018

MEMBERS OF THE AMERICAN INSTITUTE OF ARCHITECTS
COPYRIGHT 2012 ALL RIGHTS RESERVED
PRINTED OR ELECTRONIC DRAWINGS AND
DOCUMENTATION MAY NOT BE REPRODUCED
IN ANY FORM WITHOUT WRITTEN PERMISSION
FROM LS3P ASSOCIATES LTD.

REVISIONS:



PROJECT: 2402-062141
DATE: DECEMBER 3, 2012
DRAWN BY:
CHECKED BY:

SHEET 6 OF 6

SITE
DETAILS

THIS DRAWING SHALL NOT BE REPRODUCED IN ANY MANNER OR USED FOR ANY PURPOSE WITHOUT WRITTEN PERMISSION

COPYRIGHT © SEAMON, WHITESIDE & ASSOCIATES, INC.

			<p>NOTE: ALL DAM RECONSTRUCTION WORK TO BE PERFORMED IN ACCORDANCE WITH "THE FINAL GEOTECHNICAL INVESTIGATION & EARTHWORK RECOMMENDATIONS KIMBEL POND DAM REPAIRS" DATED MARCH 20, 2012 BY THE TOLLESON LIMITED COMPANY.</p>
X	X	1	DAM CROSS SECTION (NOT TO SCALE)
			<p>NOTE: 1. CONSTRUCTION MATERIALS: TREATED LUMBER - CCA OR CREOSOTE HARDWARE, STAINLESS STEEL & GALVANIZED 2. CONTRACTOR TO SUBMIT DETAILED SHOP DRAWINGS WITH DESIGN (DIMENSIONS & MATERIALS) FOR APPROVAL PRIOR TO CONSTRUCTION.</p>
X	X	2	RICE TRUNK CROSS SECTION (NOT TO SCALE)
			<p>NOTE: 1. CONSTRUCTION MATERIALS: TREATED LUMBER - CCA OR CREOSOTE HARDWARE, STAINLESS STEEL & GALVANIZED 2. CONTRACTOR TO SUBMIT DETAILED SHOP DRAWINGS WITH DESIGN (DIMENSIONS & MATERIALS) FOR APPROVAL PRIOR TO CONSTRUCTION.</p>
X	X	3	FLAPGATE (FRONT VIEW) (NOT TO SCALE)